

### 20441F-B

45° 公制内螺纹24° 锥面带O  
圈轻系列一二层连体接头  
45° METRIC FEMALE 24°  
CONE L.T.WITH O-RING ONE  
TWO-WIRE INTEGEAL FITTING

代号 PART NO.	螺纹 E THREADE	胶 管 HOSE BORE		管子外径 TUBE.O.D	尺寸 DIMENSIONS		
		公称内径 DN	标号 DASH		C	S1	H
30441F-14-04B	M14X1.5	6	04	8	2	19	27
30441F-16-05B	M16X1.5	8	05	10	2	22	28.2
30441F-18-06B	M18X1.5	10	16	12	2.5	24	29.2
30441F-22-08B	M22X1.5	12	18	15	3	27	33.2
30441F-27-10B	M27X1.5	16	10	18	2.5	32	35.9
30441F-30-12B	M30X2	20	12	22	3.5	36	42
30441F-36-16B	M36X2	25	16	28	4.5	41	34
30441F-45-20B	M45X2	32	20	35	5	55	43
30441F-52-24B	M52X2	40	24	42	6	60	42

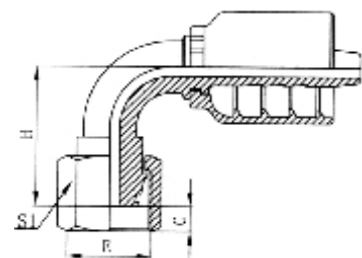

### 20491F-B

90° 公制内螺纹24° 锥面带O  
圈轻系列一二层连体接头  
90° METRIC FEMALE 24°  
CONE L.T.WITH O-RING ONE  
TWO-WIRE INTEGEAL FITTING

代号 PART NO.	螺纹 E THREADE	胶 管 HOSE BORE		管子外径 TUBE.O.D	尺寸 DIMENSIONS		
		公称内径 DN	标号 DASH		C	S1	H
20491F-14-04B	M14X1.5	6	04	8	2	19	36
20491F-16-05B	M16X1.5	8	05	10	2	22	37
20491F-18-06B	M18X1.5	10	06	12	2.5	24	42
20491F-22-08B	M22X1.5	12	08	15	3	27	45
20491F-27-10B	M27X1.5	16	10	18	2.5	32	55
20491F-30-12B	M30X2	20	12	22	3.5	36	64
20491F-36-16B	M36X2	25	16	28	4.5	41	67
20491F-45-20B	M45X2	32	20	35	5	55	76
20491F-52-24B	M52X2	40	24	42	6	60	88.5

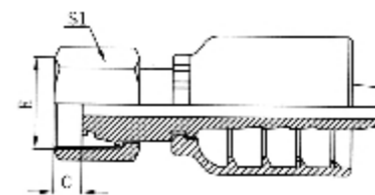

### 20511F-B

公制内螺纹24° 锥面带  
O 型圈重系列一二层连体接头  
METRIC FEMALE 24°  
CONE H.T.WITH O-RING ONE  
TWO-WIRE INTEGRAL FITTING

代号 PART NO.	螺纹 E THREADE	胶 管 HOSE BORE		管子外径 TUBE.O.D	尺寸 DIMENSIONS		
		公称内径 DN	标号 DASH		C	S	H
20511F-16-04B	M16X1.5	6	04	8	2	22	
20511F-18-04B	M18X1.5	6	04	10	2	24	
20511F-20-05B	M20X1.5	8	05	12	3	27	
20511F-20-06B	M20X1.5	10	06	12	3	27	
20511F-22-06B	M22X1.5	10	06	14	3	27	
20511F-24-08B	M24X1.5	12	08	16	3	30	
20511F-30-10B	M30X2	16	10	20	3.5	36	
20511F-36-12B	M36X2	20	12	25	3	41	
20511F-36-14B	M36X2	22	14	25	3	41	
20511F-42-16B	M42X2	25	16	30	5	50	
20511F-52-20B	M52X2	32	20	38	6.5	60	
20511F-52-24B	M52X2	40	24	38	6.5	60	

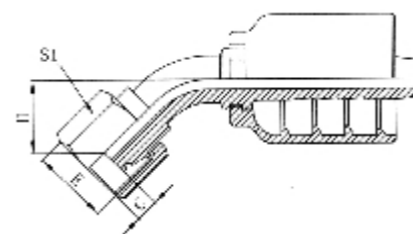

### 20541F-B

45° 公制内螺纹24° 锥面带  
O 型圈重系列一二层连体接头  
45° METRIC FEMALE 24°  
CONE H.T.WITH O-RING ONE  
TWO-WIRE INTEGRAL FITTING

代号 PART NO.	螺纹 E THREADE	胶 管 HOSE BORE		管子外径 TUBE.O.D	尺寸 DIMENSIONS		
		公称内径 DN	标号 DASH		C	S1	H
20541F-18-04B	M18X1.5	6	04	10	2	24	22.3
20541F-20-05B	M20X1.5	8	05	12	3	27	25.3
20541F-22-06B	M22X1.5	10	06	14	3	27	25.3
20541F-24-08B	M24X1.5	12	08	16	3	30	27.5
20541F-30-10B	M30X2	16	10	20	3.5	36	31
20541F-36-12B	M36X2	20	12	25	3	41	34
20541F-42-16B	M42X2	25	16	30	5	50	42.8
20541F-52-20B	M52X2	32	20	38	6.5	60	43
20541F-52-24B	M52X2	40	24	38	6.5	60	45

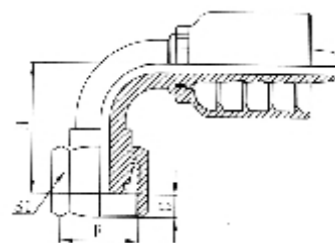

### 20591F-B

90° 公制内螺纹24° 锥面带  
O型圈重系列一二层连体接头  
90° METRIC FEMALE 24°  
CONE H.T.WITH O-RING ONE  
TWO-WIRE INTEGRAL FITTING

代号 PART NO.	螺纹 E THREADE	胶管 HOSE BORE		管子外径 TUBE O.D	尺寸 DIMENSIONS		
		公称内径 DN	标号 DASH		C	S1	H
20591F-18-04B	M18X1.5	6	04	10	2	24	36
20591F-20-05B	M20X1.5	8	05	12	3	27	44
20591F-22-06B	M22X1.5	10	06	14	3	27	46.3
20591F-24-08B	M24X1.5	12	08	16	3	30	51
20591F-30-10B	M30X2	16	10	20	3.5	36	57.5
20591F-36-12B	M36X2	20	12	25	3	41	68
20591F-42-16B	M42X2	25	16	30	5	50	77.5
20591F-52-20B	M52X2	32	20	38	6.5	60	89
20591F-52-24B	M52X2	40	24	38	6.5	60	102.5

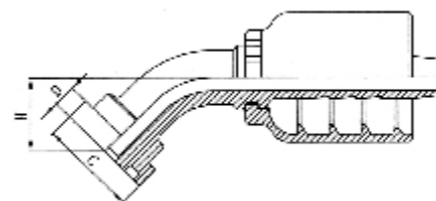

### 87341F-B

45° SAE 法兰3000PSI一二层连体接头  
45° SAE FLANGE 3000PSI FOR ONE  
TWO-WLRE INTEGRAL FITTING

代号 PART NO.	法兰型号 FLANGE SIZE	胶管 HOSE BORE		尺寸 DIMENSIONS			
		公称内径 DN	标号 DASH	C	D	L	H
87341B-08-08B	1/2"	12	08	30.2	23.9	7	23.3
87341B-12-12B	3/4"	20	12	38.1	31.7	7	29.6
87341B-16-16B	1"	25	16	44.4	38	8.2	30.4
87341B-20-20B	1.1/4"	32	20	50.8	43.2	8.2	34.5
87341B-24-24B	1.1/2"	40	24	60.3	50.3	8.2	42
87341B-32-32B	2"	50	32	71.4	62.2	9.8	49.1

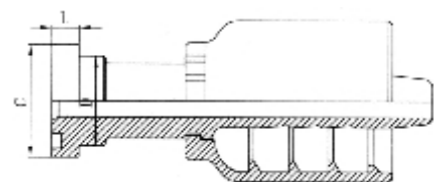

### 87311F-B

SAE 法兰3000PSI一二层连体接头  
SAE FLANGE 3000PSI FOR ONE  
TWO-WLRE INTEGRAL FITTING

代号 PART NO.	法兰型号 FLANGE SIZE	胶管 HOSE BORE		尺寸 DIMENSIONS		
		公称内径 DN	标号 DASH	C	D	L
87311F-08-08B	1/2"	12	08	30.2	23.9	7
87311F-12-12B	3/4"	20	12	38.1	31.7	7
87311F-16-16B	1"	25	16	44.4	38	8.2
87311F-20-20B	1.1/4"	32	20	50.8	43.2	8.2
87311F-24-24B	1.1/2"	40	24	60.3	50.3	8.2
87311F-32-32B	2"	50	32	71.4	62.2	9.8

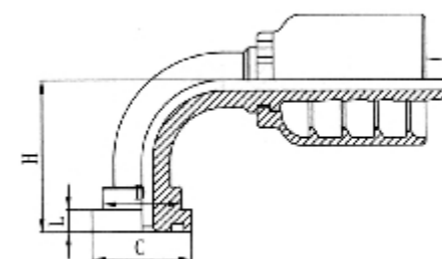

### 87391F-B

90° SAE 法兰3000PSI一二层连体接头  
90° SAE FLANGE 3000PSI FOR ONE  
TWO-WLRE INTEGRAL FITTING

代号 PART NO.	法兰型号 FLANGE SIZE	胶管 HOSE BORE		尺寸 DIMENSIONS			
		公称内径 DN	标号 DASH	C	D	L	H
87391B-08-08B	1/2"	12	08	30.2	23.9	7	47
87391B-12-12B	3/4"	20	12	38.1	31.7	7	59
87391B-16-16B	1"	25	16	44.4	38	8.2	73
87391B-20-20B	1.1/4"	32	20	50.8	43.2	8.2	83
87391B-24-24B	1.1/2"	40	24	60.3	50.3	8.2	97
87391B-32-32B	2"	50	32	71.4	62.2	9.8	118