

FL

SAE对开法兰夹 3000PSI
SAE SPLIT FLANGE CLAMPS 3000PSI
ISO 6162-SAE J518

代号 PART NO.	法兰型号 FLANGE SIZE	尺寸 DIMENSIONS					螺栓 BOLT	压力等级 MPA
		A	B	C	D	E		
FL-08	1/2"	53.8	46.1	38.1	9	17.5	M8X25	34.5
FL-12	3/4"	65	52.4	47.6	11	22.2	M10X30	
FL-16	1"	69.9	58.7	52.4	11	26.2	M10X30	
FL-20	1.1/4"	79.2	73	58.7	11	30.2	M10X30	27.6
FL-24	1.1/2"	93.7	82.6	69.9	13.5	35.7	M12X35	20.7
FL-32	2"	101.6	96.8	77.8	13.5	42.9	M12X35	
FL-40	2.1/4"	114	109	88.9	13.5	50.8	M12X40	10

注：螺栓需另订。
Note: Bolt should be ordered another

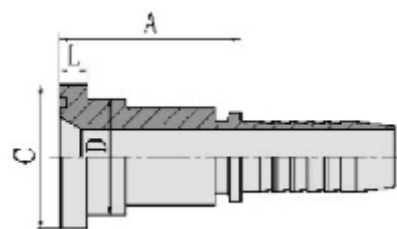

87611

SAE法兰6000PSI
SAE FLANGE 3000 PSI
ISO 12151-3-SAE J516

代号 PART Number	螺纹E THREAD E	软管 HOSE BORE		尺寸 DIMENSIONS			
		公称内径 DN	标号 DASH	A	C	D	L
87611-08-08	1/2	12	08	47	31.7	24	7.75
87611-12-10	3/4	16	10	51	41.3	32	8.76
87611-12-12	3/4	20	12	51	41.3	32	8.76
87611-16-12	1	20	12	56	47.6	38	9.53
87611-16-16	1	25	16	57	47.6	38	9.53
87611-16-20	1	32	20	61	47.6	38	9.53
87611-20-16	1.1/4	25	16	65	54	44	10.29
87611-20-20	1.1/4	32	20	66	54	44	10.29
87611-24-20	1.1/2	32	20	75	63.5	51	12.57
87611-24-24	2	40	24	75	63.5	51	12.57
87611-32-24	2	40	24	85	79.4	67	12.57
87611-32-32		50	32	85	79.4	67	12.57

注：1.表中代号用于编织软管。 2.如需用于缠绕代号改为87612-xx-xx。
Note: 1. For use with braided house 2. If use with spira house, hose fitting serise numberis 87612-xx-xx

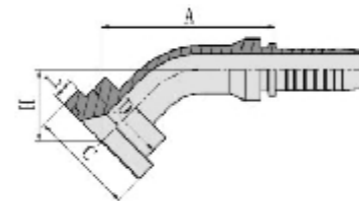

87641

45° SAE法兰6000PSI
45° SAE FLANGE 6000 PSI
ISO 12151-3-SAE J516

代号 PART Number	螺纹E THREAD E	软管 HOSE BORE		尺寸 DIMENSIONS				
		公称内径 DN	标号 DASH	A	C	D	H	L
87641-08-08	1/2	12	08	58.9	31.7	24	24	7.75
87641-08-12	1/2	20	12	74.9	31.7	24	27.5	7.75
87641-12-10	3/4	16	10	72.5	41.3	32	28.2	8.76
87641-12-12	3/4	20	12	79.2	41.3	32	31.8	8.76
87641-16-16	1	25	16	90.2	47.6	38	34.7	9.53
87641-20-20	1.1/4	32	20	103.8	54	44	41.5	10.29
87641-24-20	1.1/2	32	20	105.8	63.5	51	45.1	12.57
87641-24-24	2	40	24	116.2	63.5	51	45.5	12.57
87641-32-24	2	40	24	125.4	79.4	67	54.7	12.57
87641-32-32		50	32	135.7	79.4	67	52.7	12.57

注：1.表中代号用于编织软管。 2.如需用于缠绕代号改为87642-xx-xx。
Note: 1. For use with braided house 2. If use with spira house, hose fitting serise numberis 87642-xx-xx

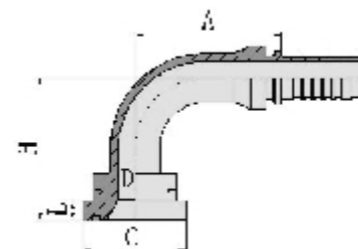

87691

90° SAE法兰3000PSI
90° SAE FLANGE 3000 PSI
ISO 12151-3-SAE J516

代号 PART Number	螺纹E THREAD E	软管 HOSE BORE		尺寸 DIMENSIONS				
		公称内径 DN	标号 DASH	A	C	D	H	L
87691-08-08	1/2	12	08	41	31.7	24	48	7.75
87691-12-10	3/4	16	10	56.5	41.3	32	56.5	8.76
87691-12-12	3/4	20	12	66.2	41.3	32	66	8.76
87691-16-12	1	20	12	66.2	47.6	38	69	9.53
87691-16-16	1	25	16	78	47.6	38	74.5	9.53
87691-16-20	1	32	20	91.5	47.6	38	85.5	9.53
87691-20-16	1.1/4	25	16	78	54	44	78.5	10.29
87691-20-20	1.1/4	32	20	91.5	54	44	89.5	10.29
87691-24-20	1.1/2	32	20	91.5	63.5	51	94.5	12.57
87691-24-24	2	40	24	109.4	63.5	51	108	12.57
87691-32-24	2	40	24	109.4	79.4	67	116	12.57
87691-32-32		50	32	131.8	79.4	67	136.3	12.57

注：1.表中代号用于编织软管。 2.如需用于缠绕代号改为87692-xx-xx。
Note: 1. For use with braided house 2. If use with spira house, hose fitting serise numberis 87692-xx-xx

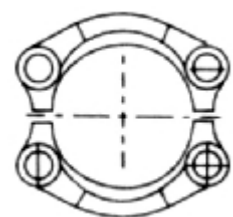

FS

SAE 对开法兰夹 6000 PSI
SAE SPLIT FLANGE CLAMPS 6000 PSI
ISO 6162-SAE J518

代号 PART NO.	法兰型号 FLANGE SIZE	尺寸 DIMENSIONS					螺栓 BOLT	压力等级 MPA
		A	B	C	D	E		
FS-08	1/2"	56.3	49.2	40.5	9	18.2	M8X30	42
FS-12	3/4"	71.4	61.8	50.8	11	23.8	M10X35	
FS-16	1"	81	71.4	57.2	13	27.8	M12X45	
FS-20	1.1/4"	95.3	79.2	66.7	15	31.8	M14X50	
FS-24	1.1/2"	112.8	96.8	79.4	17	36.6	M16X55	
FS-32	2"	133.4	115.6	96.8	21	44.4	M20X70	

注：螺栓需另订。
Note: Bolt should be ordered another

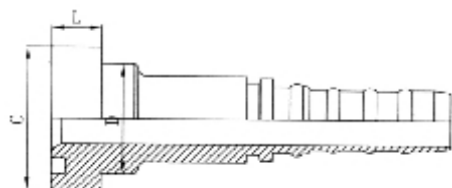

87913

SAE 法兰 6000PSI 内锁式
SAE FLANGE 6000PSI INTERLOCK

代号 PART NO.	法兰型号 FLANGE SIZE	软管 HOSE BORE		尺寸 DIMENSIONS		
		公称内径 DN	标号 DASH	C	D	L
87913-08-08	1/2"	12	08	31.8	23.9	14.3
87913-12-12	3/4"	20	12	41.3	31.7	14.3
87913-16-16	1"	25	16	47.6	38	14.3
87913-20-20	1.1/4"	32	20	54	43.6	14.3
87913-24-24	1.1/2"	40	24	63.5	50.8	14.3
87913-32-32	2"	50	32	79.4	66.5	14.3

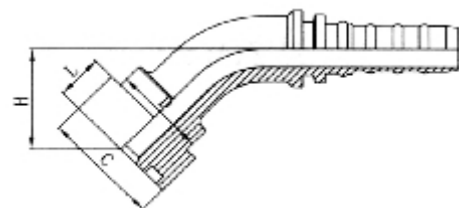

87943

45° SAE 法兰 9000PSI 内锁式
45° SAE FLANGE 9000PSI INTERLOCK

代号 PART NO.	法兰型号 FLANGE SIZE	软管 HOSE BORE		尺寸 DIMENSIONS			
		公称内径 DN	标号 DASH	C	D	L	H
87943-08-08	1/2"	12	08	31.8	23.9	14.3	30.5
87943-12-12	3/4"	20	12	41.3	31.7	14.3	35.6
87943-16-16	1"	25	16	47.6	38	14.3	37.5
87943-20-20	1.1/4"	32	20	54	43.6	14.3	42.3
87943-24-24	1.1/2"	40	24	63.5	50.8	14.3	46.9
87943-32-32	2"	50	32	79.4	66.5	14.3	61.5

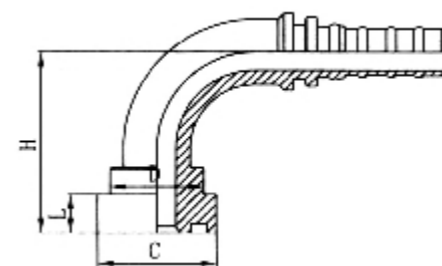

87993

90° SAE 法兰 9000PSI 内锁式
90° SAE FLANGE 9000PSI INTERLOCK

代号 PART NO.	法兰型号 FLANGE SIZE	软管 HOSE BORE		尺寸 DIMENSIONS			
		公称内径 DN	标号 DASH	C	D	L	H
87993-08-08	1/2"	12	08	31.8	23.9	14.3	40.5
87993-12-12	3/4"	20	12	41.3	31.7	14.3	71.5
87993-16-16	1"	25	16	47.6	38	14.3	78.5
87993-20-20	1.1/4"	32	20	54	43.6	14.3	90.5
87993-24-24	1.1/2"	40	24	63.5	50.8	14.3	105
87993-32-32	2"	50	32	79.4	66.5	14.3	124

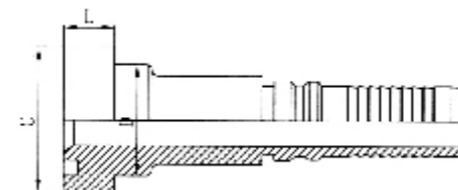

87913L

SAE 法兰 9000PSI 内锁式加强
SAE FLANGE 9000PSI INTERLOCK
STRENGTHEN

代号 PART NO.	法兰型号 FLANGE SIZE	软管 HOSE BORE		尺寸 DIMENSIONS		
		公称内径 DN	标号 DASH	C	D	L
87913L-20-20	1.1/4"	32	20	54	43.6	14.3
87913L-24-24	1.1/2"	40	24	63.5	50.8	14.3
87913L-32-32	2"	50	32	79.4	66.5	14.3

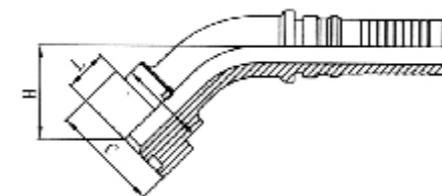

87943L

45° SAE 法兰 9000PSI 内锁式加强
45° SAE FLANGE 9000PSI INTERLOCK
STRENGTHEN

代号 PART NO.	法兰型号 FLANGE SIZE	软管 HOSE BORE		尺寸 DIMENSIONS			
		公称内径 DN	标号 DASH	C	D	L	H
87943L-20-20	1.1/4"	32	20	54	43.6	14.3	42.3
87943L-24-24	1.1/2"	40	24	63.5	50.8	14.3	46.9
87943L-32-32	2"	50	32	79.4	66.5	14.3	61.5