

20591

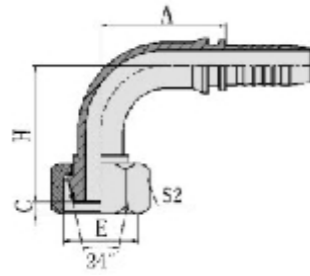

20591-T

90° 公制内螺纹24° 锥带O形圈重系列  
 90° METRIC FEMALE 24° CONE O-RINGH.T.  
 ISO12151-2-DIN 3865

代号 PART Number	螺纹E THREAD E	软管 HOSE BORE		管子外径 TUBE.O.D	O形圈 O RING	尺寸 DIMENSIONS			
		公称内径 DN	标号 DASH			A	C	H	S2
20591-14-04	M14 × 1.5	6	04	6	O04.5 × 1.5	30	1.1	47.5	19
20591-16-05	M16 × 1.5	8	05	8	O06.5 × 1.5	33	1.5	51	22
20591-18-06	M18 × 1.5	10	06	10	O08.0 × 1.5	35.3	2	52.8	24
20591-20-08	M20 × 1.5	12	08	12	O10.0 × 1.5	41	2.5	61	27
20591-22-08	M22 × 1.5	12	08	14	O11.0 × 2.0	41	2.5	61	27
20591-24-08T	M24 × 1.5	12	08	16	O13.0 × 2.0	41	3	53	30
20591-30-10T	M30 × 2	16	10	20	O16.3 × 2.4	56.5	3	60.5	36
20591-30-12	M30 × 2	20	12	20	O16.3 × 2.4	65.5	3	81	36
20591-36-12T	M36 × 2	20	12	25	O20.3 × 2.4	66.2	3	70	41
20591-36-14T	M36 × 2	22	14	25	O20.3 × 2.4	71.2	3	71	41
20591-42-16T	M42 × 2	25	16	30	O25.3 × 2.4	78	5	77.5	50
20591-52-20T	M52 × 2	32	20	38	O33.3 × 2.4	93	6.5	89	60
20591-52-24T	M52 × 2	40	24	38	O33.3 × 2.4	109.4	6.5	103	60

注：1.表中代号用于编织软管。  
 Note : 1.For uses with braided hoses

2.如需用于缠绕软管代号改为20592-xx-xx。  
 2.If use with spiral hoses,hose fitting series number is 20592-xx-xx.

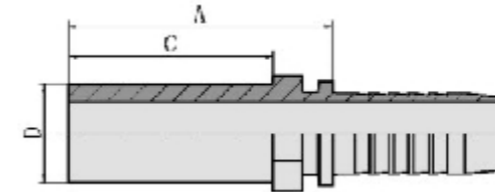

50011

卡套式直管  
 METRIC STANDPIPE STRAIGHT  
 DIN 2353

代号 PART Number	管子外径 TUBE.O.D	软管 HOSE BORE		尺寸 DIMENSIONS		备注 NOTE
		公称内径 DN	标号 DASH	A	C	
50011-06-04	6	6	04	29	22	轻系列
50011-10-05	10	8	05	31	23	
50011-12-08	12	12	08	33	23	
50011-15-08	15	12	08	35.5	25	
50011-18-10	18	16	10	36.5	26	
50011-22-12	22	20	12	44	28	
50011-28-16	28	25	16	47	30	
50011-35-20	35	32	20	56	36	
50011-42-24	42	40	24	62	40	
50011-08-04	08	6	04	31	24	
50011-10-04	10	6	04	35	26	
50011-12-05	12	8	05	35.5	26	
50011-14-06	14	10	06	39.5	29	
50011-14-12	14	20	12	45.5	29	
50011-16-08	16	12	08	41	30	
50011-16-10	16	16	10	45.5	30	
50011-20-12	20	20	12	52.5	36	
50011-25-16	25	25	16	57	40	
50011-30-16	30	25	16	63	44	
50011-30-20	30	32	20	64	44	
50011-38-16	38	25	16	69	50	
50011-38-20	38	32	20	70	50	

注：1.表中代号用于编织软管。  
 Note : 1.For uses with braided hoses

2.如需用于缠绕软管代号改为50012-xx-xx。  
 2.If use with spiral hoses,hose fitting series number is 50012-xx-xx.

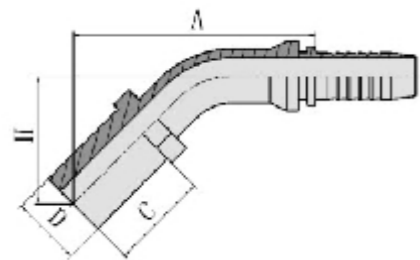

### 50041

45° 公制卡套式直管  
45° METRIC STANDPIPE STRAIGHT  
DIN 2353

代号 PART Number	管子外径 TUBE.O.D	软管 HOSE BORE		尺寸 DIMENSIONS			备注 NOTE	
		公称内径 DN	标号 DASH	A	C	H		
50041-06-03	6	5	04	47.8	22	27.5	轻系列	
50041-06-04	6	6	06	52.2	22	30.1		
50041-08-05	8	8	05	55.7	24	32.4		
50041-08-06	8	10	06	57.9	24	33.1		
50041-10-05	10	8	05	54	23	30.6		
50041-10-06	10	10	06	56.1	23	31.3		
50041-12-06	12	10	06	58.5	23	34.5		
50041-12-08	12	12	08	72.4	23	37.4		
50041-15-06	15	10	06	59.3	25	34.5		
50041-15-08	15	12	08	70.6	25	35.7		
50041-18-08	18	12	08	73.4	26	38.5		
50041-18-10	18	16	10	84.6	26	39.8		
50041-22-10	22	16	06	87.1	28	42.3		
50041-22-12	22	20	12	93.3	28	45.9		
50041-22-16	22	25	16	100.9	28	46.7		
50041-28-16	28	25	16	103.7	30	49.5		
50041-35-20	35	32	20	118.5	36	57.8		
50041-08-04	08	6	04	53.6	24	31.5		重系列
50041-10-04	10	6	04	54	26	31.9		
50041-12-01	12	6	01	57.1	26	35.1		
50041-12-05	12	8	05	59.2	26	35.9		
50041-14-06	14	10	06	61.6	29	37.3		
50041-14-08	14	12	08	73.8	29	38.8		
50041-14-12	14	20	12	91.9	29	43.8		
50041-16-08	16	12	08	76.6	30	41.7		
50041-16-10	16	16	10	87.8	30	43		
50041-20-10	20	16	06	92.8	36	48		
50041-20-12	20	20	12	100.7	36	52.6		
50041-25-12	25	20	06	101.8	40	54.4		
50041-25-16	25	25	16	109.4	40	55.2		
50041-30-16	30	25	06	113.6	44	59.4		
50041-30-20	30	32	20	124.2	44	63.5		
50041-38-16	38	25	06	117.9	50	63.6		
50041-38-20	38	32	20	128.4	50	67.7		

注：1.表中代号用于编织软管。

2.如需用于缠绕软管代号改为50042-xx-xx。

Note : 1.For uses with braided hoses

2.If use with spiral hoses,hose fitting series number is 50042-xx-xx.

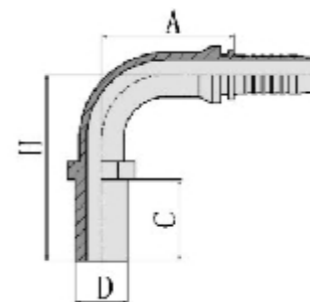

### 50091

90° 公制卡套式直管  
90° METRIC STANDPIPE STRAIGHT  
DIN 2353

代号 PART Number	管子外径 TUBE.O.D	软管 HOSE BORE		尺寸 DIMENSIONS			备注 NOTE
		公称内径 DN	标号 DASH	A	C	H	
50091-06-04	6	6	04	30	22	48	轻系列
50091-08-06	8	10	06	35.8	24	57.8	
50091-10-06	10	10	06	35.3	23	55.3	
50091-12-08	12	12	08	41	23	67	
50091-15-08	15	12	08	41	25	65	
50091-18-10	18	16	10	56.5	26	73	
50091-22-12	22	20	12	65.5	28	86	
50091-28-16	28	25	16	76.7	30	95.5	
50091-35-20	35	32	20	91.5	36	112.5	
50091-08-04	08	6	04	30	24	52.2	
50091-12-05	12	8	05	33	26	60.5	
50091-14-06	14	10	06	35.3	29	63.8	
50091-14-12	14	20	12	66.2	29	83	
50091-16-08	16	12	08	42	30	73	
50091-16-10	16	16	10	56.5	30	77.5	
50091-20-12	20	20	12	65.5	36	95.5	
50091-25-16	28	25	16	76.7	40	103.5	
50091-30-16	30	25	16	78	40	109.5	
50091-30-20	30	32	20	91.5	44	120.5	
50091-38-16	38	25	16	76.7	50	115.5	
50091-38-20	38	32	20	91.5	50	126.5	

注：1.表中代号用于编织软管。

2.如需用于缠绕软管代号改为50092-xx-xx。

Note : 1.For uses with braided hoses

2.If use with spiral hoses,hose fitting series number is 50092-xx-xx.