

90° 公制内螺纹24° 锥带O形圈轻系列
90° METRIC FEMALE 24° CONE O-RING L.T.
ISO12151-2-DIN 3865

代号 PART Number	螺纹E THREAD E	软管 HOSE BORE		管子外径 TUBE.O.D	O形圈 O RING	尺寸 DIMENSIONS			
		公称内径 DN	标号 DASH			A	C	H	S2
20491-12-04	M12×1.5	6	04	6	O04.5×1.5	30	1	44.5	17
20491-14-04	M14×1.5	6	04	8	O06.5×1.5	30	2	46	19
20491-16-05	M16×1.5	8	05	10	O08.0×1.5	33	2	49.5	22
20491-18-06	M18×1.5	10	06	12	O10.0×1.5	35.3	2.5	53.3	24
20491-22-08	M22×1.5	12	08	15	O12.0×2.0	41	2.5	61	27
20491-26-10	M26×1.5	16	10	18	O15.0×2.0	56.5	2.5	67.5	32
20491-27-10T	M27×1.5	16	10	18	O15.0×2.0	56.5	2.5	67.5	32
20491-30-10T	M30×2	16	10	22	O20.0×2.0	56.5	4	57.2	36
20491-30-12	M30×2	20	12	22	O20.0×2.0	65.5	4	80	36
20491-36-12T	M36×2	20	12	28	O26.0×2.0	65.5	4	69	41
20491-36-14T	M36×2	22	14	28	O26.0×2.0	71.2	4	70	41
20491-45-16T	M45×2	25	16	35	O32.0×2.5	76.7	5	75	55
20491-45-20T	M45×2	32	20	35	O32.0×2.5	91.5	5	88.5	55
20491-52-24T	M52×2	40	24	42	O38.0×2.5	109.4	5.5	104	60

注：1.表中代号用于编织软管。 2.如需用于缠绕软管代号改为20492-xx-xx。
Note: 1.For uses with braided hoses 2.If use with spiral hoses,hose fitting series number is 20492-xx-xx.

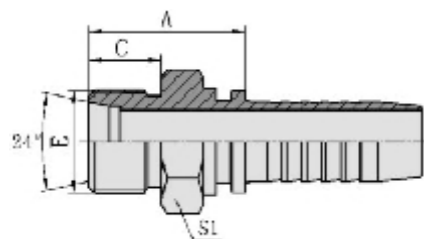

10511
公制外螺纹24° 内锥面重系列
METRIC MALE 24° CONE SEAT H.T.
ISO8434-1-DIN 3861

代号 PART Number	螺纹E THREAD E	软管 HOSE BORE		管子外径 TUBE.O.D	尺寸 DIMENSIONS		
		公称内径 DN	标号 DASH		A	C	S2
10511-16-04	M16×1.5	6	04	8	26.5	12	17
10511-18-04	M18×1.5	6	04	10	26.5	12	19
10511-20-06	M20×1.5	10	06	12	26.5	12	22
10511-24-08	M24×1.5	12	08	16	31.5	14	27
10511-30-10	M30×2	16	10	20	36	16	32
10511-36-12	M36×2	20	12	25	40.5	18	41
10511-42-16	M42×2	25	16	30	44	20	46
10511-52-20	M52×2	32	20	38	52	22	55

注：1.表中代号用于编织软管。 2.如需用于缠绕软管代号改为10512-xx-xx。
Note: 1.For uses with braided hoses 2.If use with spiral hoses,hose fitting series number is 10512-xx-xx.

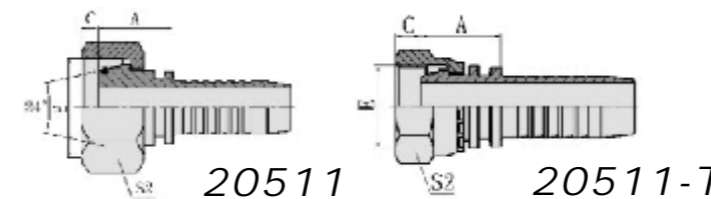

公制内螺纹24° 锥带O形圈轻系列
METRIC FEMALE 24° CONE O-RING H.T.
ISO12151-1-DIN 3865

代号 PART Number	螺纹E THREAD E	软管 HOSE BORE		管子外径 TUBE.O.D	O形圈 O RING	尺寸 DIMENSIONS		
		公称内径 DN	标号 DASH			A	C	S2
20511-14-04	M14×1.5	6	04	6	O04.5×1.5	28.5	1.1	19
20511-16-05	M16×1.5	8	05	8	O06.5×1.5	29	1.5	22
20511-18-06	M18×1.5	10	06	10	O08.0×1.5	29	2	24
20511-20-08	M20×1.5	12	08	12	O10.0×1.5	31.5	2.5	27
20511-22-08	M22×1.5	12	08	14	O11.0×2.0	31.5	2.5	27
20511-24-08T	M24×1.5	12	08	16	O13.0×2.0	30	3	30
20511-30-10T	M30×2	16	10	20	O16.3×2.4	36	3	36
20511-30-12	M30×2	20	12	20	O16.3×2.4	39	3	36
20511-36-12T	M36×2	20	12	25	O20.3×2.4	36	3	41
20511-36-14T	M36×2	22	14	25	O20.3×2.4	36	3	41
20511-42-12T	M42×2	20	12	30	O25.3×2.4	40	5	50
20511-42-16T	M42×2	25	16	30	O25.3×2.4	41	5	50
20511-52-20T	M52×2	32	20	38	O33.3×2.4	44	6.5	60
20511-52-24T	M52×2	40	24	38	O33.3×2.4	44	6.5	60

注：1.表中代号用于编织软管。 2.如需用于缠绕软管代号改为20512-xx-xx。
Note: 1.For uses with braided hoses 2.If use with spiral hoses,hose fitting series number is 20512-xx-xx.

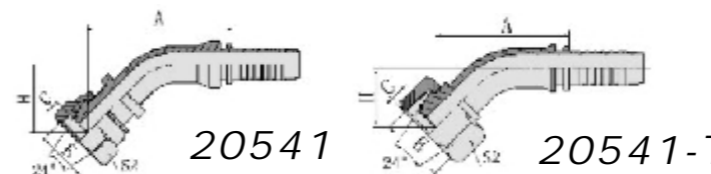

45° 公制内螺纹24° 锥带O形圈重系列
45° METRIC FEMALE 24° CONE O-RING H.T.
ISO12151-2-DIN 3865

代号 PART Number	螺纹E THREAD E	软管 HOSE BORE		管子外径 TUBE.O.D	O形圈 O RING	尺寸 DIMENSIONS			
		公称内径 DN	标号 DASH			A	C	H	S2
20541-14-04	M14×1.5	6	04	6	O04.5×1.5	50.1	1.1	28	19
20541-16-05	M16×1.5	8	05	8	O06.5×1.5	52.2	1.5	28.9	22
20541-18-06	M18×1.5	10	06	10	O08.0×1.5	54.3	2	29.6	24
20541-20-08	M20×1.5	12	08	12	O10.0×1.5	67.8	2.5	32.8	27
20541-22-08	M22×1.5	12	08	14	O11.0×2.0	68.1	2.5	33.2	27
20541-24-08T	M24×1.5	12	08	16	O13.0×2.0	62.5	3	27.5	30
20541-30-10T	M30×2	16	10	20	O16.3×2.4	75.8	3	31	36
20541-30-12	M30×2	20	12	20	O16.3×2.4	90.5	3	42.4	36
20541-36-12T	M36×2	20	12	25	O20.3×2.4	82.7	3	34.6	41
20541-36-14T	M36×2	22	14	25	O20.3×2.4	84.4	3	34	41
20541-42-16T	M42×2	25	16	30	O25.3×2.4	92.3	5	36.8	50
20541-52-20T	M52×2	32	20	38	O33.3×2.4	103.4	6.5	41.2	60
20541-52-24T	M52×2	40	24	38	O33.3×2.4	115.9	6.5	45.1	60

注：1.表中代号用于编织软管。 2.如需用于缠绕软管代号改为20542-xx-xx。
Note: 1.For uses with braided hoses 2.If use with spiral hoses,hose fitting series number is 20542-xx-xx.

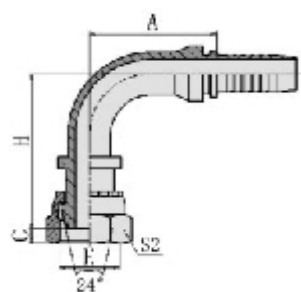

20591

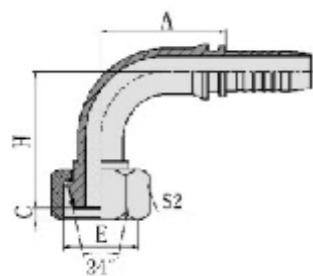

20591-T

90° 公制内螺纹24° 锥带O形圈重系列
 90° METRIC FEMALE 24° CONE O-RINGH.T.
 ISO12151-2-DIN 3865

代号 PART Number	螺纹E THREAD E	软管 HOSE BORE		管子外径 TUBE.O.D	O形圈 O RING	尺寸 DIMENSIONS			
		公称内径 DN	标号 DASH			A	C	H	S2
20591-14-04	M14 × 1.5	6	04	6	O04.5 × 1.5	30	1.1	47.5	19
20591-16-05	M16 × 1.5	8	05	8	O06.5 × 1.5	33	1.5	51	22
20591-18-06	M18 × 1.5	10	06	10	O08.0 × 1.5	35.3	2	52.8	24
20591-20-08	M20 × 1.5	12	08	12	O10.0 × 1.5	41	2.5	61	27
20591-22-08	M22 × 1.5	12	08	14	O11.0 × 2.0	41	2.5	61	27
20591-24-08T	M24 × 1.5	12	08	16	O13.0 × 2.0	41	3	53	30
20591-30-10T	M30 × 2	16	10	20	O16.3 × 2.4	56.5	3	60.5	36
20591-30-12	M30 × 2	20	12	20	O16.3 × 2.4	65.5	3	81	36
20591-36-12T	M36 × 2	20	12	25	O20.3 × 2.4	66.2	3	70	41
20591-36-14T	M36 × 2	22	14	25	O20.3 × 2.4	71.2	3	71	41
20591-42-16T	M42 × 2	25	16	30	O25.3 × 2.4	78	5	77.5	50
20591-52-20T	M52 × 2	32	20	38	O33.3 × 2.4	93	6.5	89	60
20591-52-24T	M52 × 2	40	24	38	O33.3 × 2.4	109.4	6.5	103	60

注：1.表中代号用于编织软管。
 Note : 1.For uses with braided hoses

2.如需用于缠绕软管代号改为20592-xx-xx。
 2.If use with spiral hoses,hose fitting series number is 20592-xx-xx.

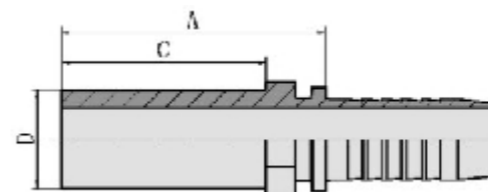

50011
 卡套式直管
 METRIC STANDPIPE STRAIGHT
 DIN 2353

代号 PART Number	管子外径 TUBE.O.D	软管 HOSE BORE		尺寸 DIMENSIONS		备注 NOTE
		公称内径 DN	标号 DASH	A	C	
50011-06-04	6	6	04	29	22	轻系列
50011-10-05	10	8	05	31	23	
50011-12-08	12	12	08	33	23	
50011-15-08	15	12	08	35.5	25	
50011-18-10	18	16	10	36.5	26	
50011-22-12	22	20	12	44	28	
50011-28-16	28	25	16	47	30	
50011-35-20	35	32	20	56	36	
50011-42-24	42	40	24	62	40	
50011-08-04	08	6	04	31	24	
50011-10-04	10	6	04	35	26	
50011-12-05	12	8	05	35.5	26	
50011-14-06	14	10	06	39.5	29	
50011-14-12	14	20	12	45.5	29	
50011-16-08	16	12	08	41	30	
50011-16-10	16	16	10	45.5	30	
50011-20-12	20	20	12	52.5	36	
50011-25-16	25	25	16	57	40	
50011-30-16	30	25	16	63	44	
50011-30-20	30	32	20	64	44	
50011-38-16	38	25	16	69	50	
50011-38-20	38	32	20	70	50	

注：1.表中代号用于编织软管。
 Note : 1.For uses with braided hoses

2.如需用于缠绕软管代号改为50012-xx-xx。
 2.If use with spiral hoses,hose fitting series number is 50012-xx-xx.